

# For Those Who Don't Believe In Meeting By Chance.



When it's up to you to put important people together, you want to be sure details won't be left until last. Rest assured that while business guests find our inn romantic, they never find our arrangements spontaneous. Nor is there mystery in our accommodations and amenities; they are clearly superior. Oversized suites and rooms with high ceilings and period-style furnishings. A formal Charleston garden courtyard for receptions. The internationally acclaimed cuisine and libations of *Peninsula Grill*.

Our origins pre-date copiers, laptops and fax machines, but you'll discover we're rather plugged-in to the needs of business guests. Elegant colonial meeting rooms. Private bar service and gourmet banquet meals by award-winning Chef Robert Carter. Proprietor's and Governors' suites for executive and breakout sessions.

You see, we can do everything a large hotel can, but it will be just for you. And with nothing left to fate, your meeting here will be a success of historic proportions.



**PLANTERS INN**  
CHARLESTON, SC  
circa 1844

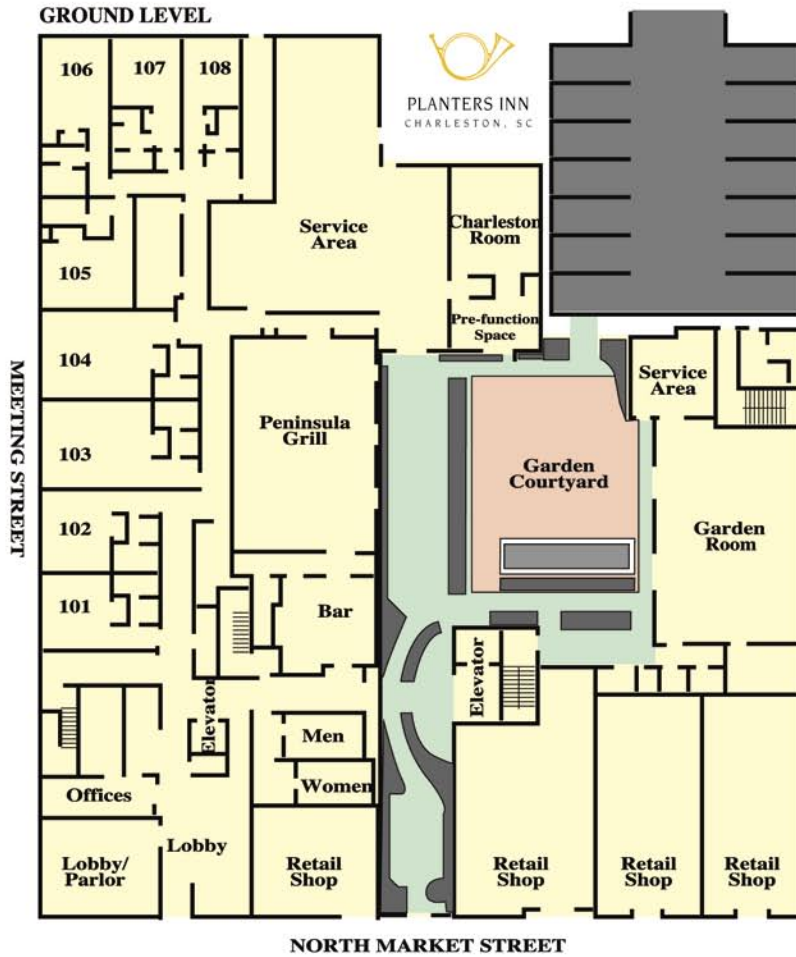

	Dimensions	Square Footage	Ceiling Height	Banquet (60" tables of 8)	Theatre	Schoolroom (18" tables of 3)	Hollow Square	Reception
Garden Room	46 X 31 10 X 5	1475	11	96	150	80	50	150
Garden Piazza	5 X 6 25 X 8	518	11	n/a	n/a	n/a	n/a	50
Charleston Room	23 X 19	437	10	32	50	30	20	50
Charleston Room Pre-Function Space	19 X 10	190	9	n/a	n/a	n/a	n/a	20
Courtyard Garden	60 X 54	3240	n/a	n/a	n/a	n/a	n/a	200
Peninsula Grill	46 X 31	1426	9.5	96	150	80	50	150
2nd Floor Terrace	28 X 19	565	n/a	n/a	n/a	n/a	n/a	60
4th Floor Terrace	75 X 26	1950	n/a	n/a	n/a	n/a	n/a	150
Living Room of Proprietor's Suite	18 X 15 9 X 8	405	11	n/a	30	18	20	30
Living Room of Governors' Suites	19 X 13	247	11	n/a	n/a	n/a	8	n/a