



## Meet at Charleston's **SUITE SPOT**

Oversized Suites. Overlooking The Market.

Imagine your next company event taking place in the heart of historic Charleston. Where your guests are just a short walk from four-star dining, antebellum mansions, King Street boutiques, Waterfront Park and horse-drawn carriage rides. Beyond the hotel's chandeliered lobby, they'll have over 10,000 square feet of meeting space for groups up to 480. And you can relax knowing everything is orchestrated by our Conference Services Managers. Then, after a productive day, your associates can unwind in deluxe kings or oversized one and two bedroom suites that feature our Sweet Dreams® by Doubletree Sleep Experience.



DOUBLETREE  
GUEST SUITES™  
HISTORIC CHARLESTON



## Charlestonian Ballroom



## Stono Conference Center

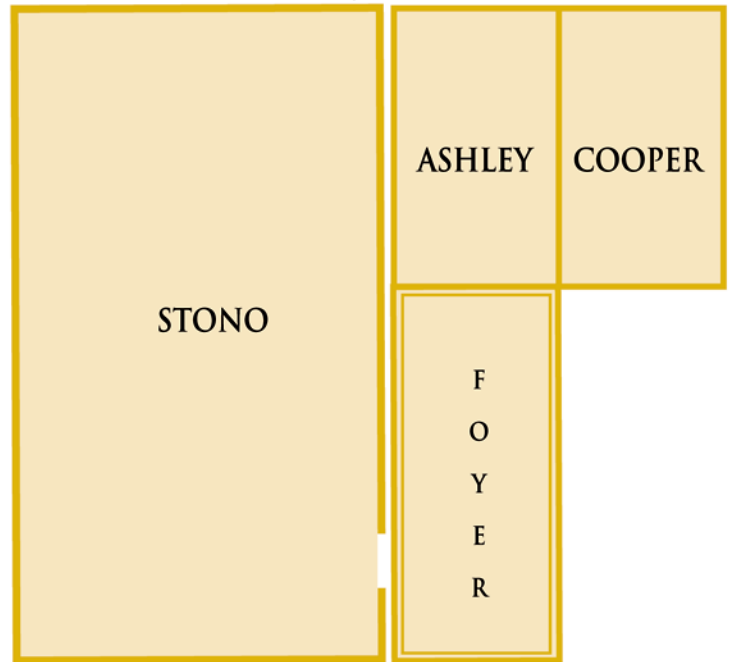

<i>Meeting Room</i>	<i>Square Feet</i>	<i>Room Size</i>	<i>Ceiling Height</i>	<i>Classroom</i>	<i>Theatre</i>	<i>Banquet</i>	<i>Reception</i>	<i>Conference</i>	<i>U-Shape</i>	<i>Hollow Square</i>
<i>Charlestonian</i>	3354	78x43	14	250	480	280	350	100	90	100
<i>Harleston</i>	1247	29x43	14	96	126	120	130	47	38	47
<i>Wraggborough</i>	1075	25x43	14	65	108	80	110	41	33	41
<i>Ansonborough</i>	1032	24x43	14	65	108	80	110	41	33	41
<i>Stono Ballroom</i>	2705	77x35	12	180	300	200	300	85	78	85
<i>Ashley</i>	656	35x18	8	40	70	50	60	28	24	30
<i>Cooper</i>	656	36x18	8	40	70	50	60	28	24	30
<i>Edisto</i>	505	23x22	10	28	50	40	50	22	18	21
<i>Wando</i>	418	16x25	10	24	40	24	40	18	15	18
<i>Kiawah</i>	361	14x23	8	18	30	16	30	12	10	12
<i>Café &amp; Lounge</i>	1800	n/a	10	n/a	n/a	65	100	n/a	n/a	n/a
<i>Palmetto Courtyard</i>	n/a	n/a	n/a	n/a	n/a	125	175	n/a	n/a	n/a